



# FOX PARK

Nolanville, Texas



# Agenda

- Current Inventory
- Needs Assessment
- Public Engagement
- Concept Plan
- Implementation

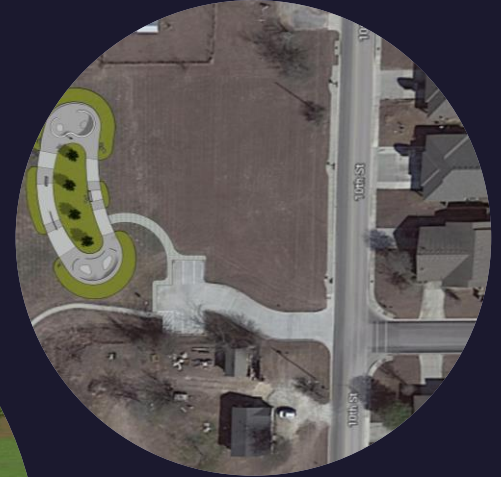



1 – Playground, 2 slides  
2 – Benches  
1 – Irrigation/vegetation

List Needs:

# Introduction

## Current Inventory

- Fox Park was added to the City inventory in 2014 as a dedication from Oakridge apartments. Oakridge is responsible for the upkeep of the existing playground for 10 years. It is about one acre in size.
- Current inventory consist of landscape irrigation, playground, bench and parking lot with approximately 10 spots.
- Connects to JW Sims by way of sidewalk on 10<sup>th</sup> Street. Offers potential off system pedestrian connection to east side of City – off road.

# The way to get started is to quit talking and begin doing.

Walt Disney

Public Engagement:

- 1.) Hearing scheduled
- 2.) Survey Needed
- 3.) Video w/ Planning & Zoning?



What else should we do to get the word out?



# Concept Plan

## Fox Park



- ❑ 5000 sq ft Skate Park, with trees lining pump track.
- ❑ Obstacle Course
- ❑ Rehab Playground, relocate equipment from Sims
- ❑ New teeny tiny equipment

# Suggested Budget for Fox Park

- Grant match used to install:

Obstacle Course (~\$40,000)

Pavilion (\$40,000)

Landscape (\$10,000)

Relocation & Rehab for Community Center Playground (3 pieces) and tables (2) (\$15,000)

Shade Structure Playground (???)

Rehab existing tot lot & surfacing (\$20,000)

Add teeny tiny tot lot (20,000)

Benches at Park

Table

Dog Waste

Bike Repair Station

\$200,000 Skate Park – prearranged for TPW grant match in the event of winning authorization for local park grant (\$150,000).



\$5000 Combined

# Budget

	Category 1	Category 2	Category 3	Category 4
Item 1	4.5	2.3	1.7	5
Item 2	3.2	5.1	4.4	3
Item 3	2.1	1.7	2.5	2.8
Item 4	4.5	2.2	1.7	7

Pending



# Timeline

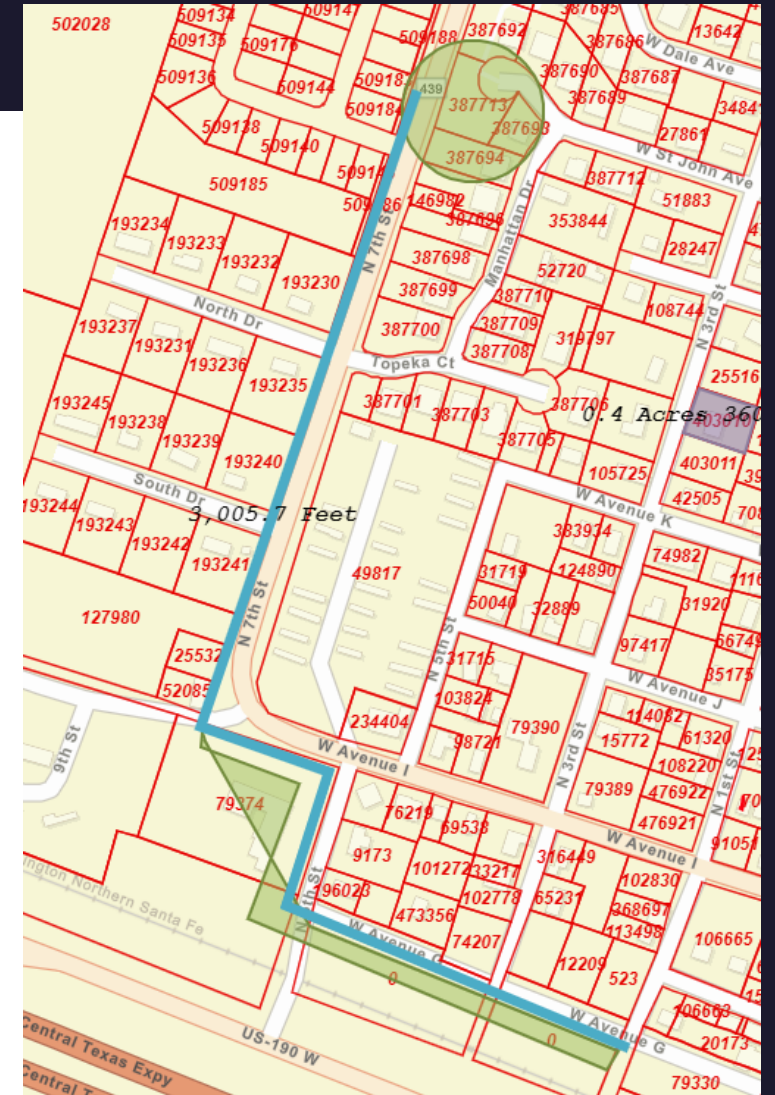

[illegible]

# Thank You

Jessica Navarro

[jnavarro@nolanvilletx.gov](mailto:jnavarro@nolanvilletx.gov)

[www.nolanvilletx.gov](http://www.nolanvilletx.gov)

